

ENGINEERING EMOTIONS

O-I France SAS
2 Rue Maurice Moissonnier
69120 Vaulx-en-Velin, France
Tel. +33 (0)426686500

CONTAINER & MOULD DESIGN
EUROPE

NOTES:
THIS DRAWING IS THE PROPERTY OF O-I AND
MUST NOT BE REPRODUCED OR DISCLOSED
WITHOUT O-I WRITTEN AUTHORIZATION.

ONLY TOLERANCED DIMENSIONS ARE GUARANTEED.

MANUFACTURING MARKINGS SHOWN ARE FOR ILLUSTRATIVE
PURPOSES ONLY, ACTUAL MARKINGS ON CONTAINER
MAY DIFFER, DEPENDANT ON LOCAL LEGISLATION.

16/07/2024

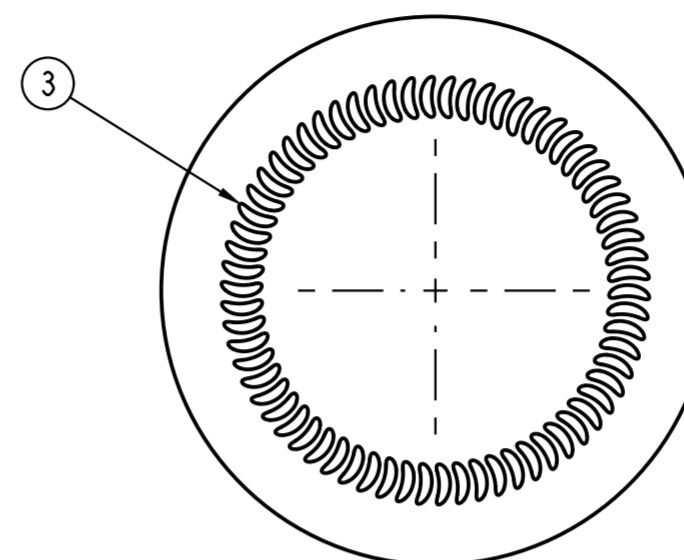
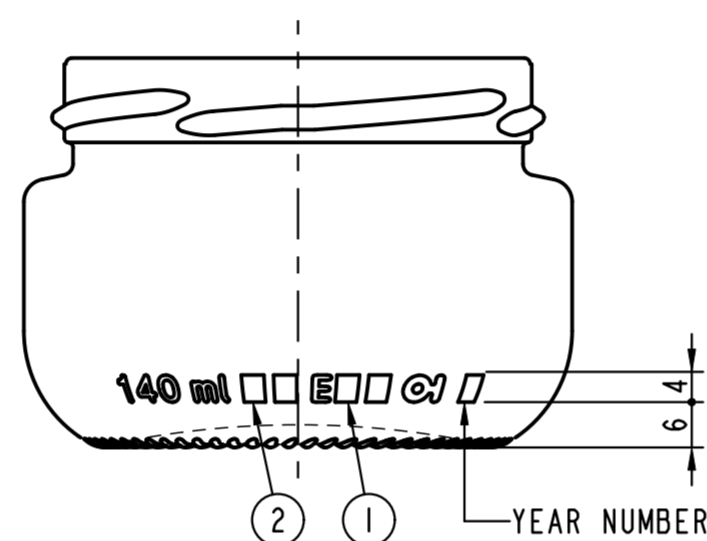
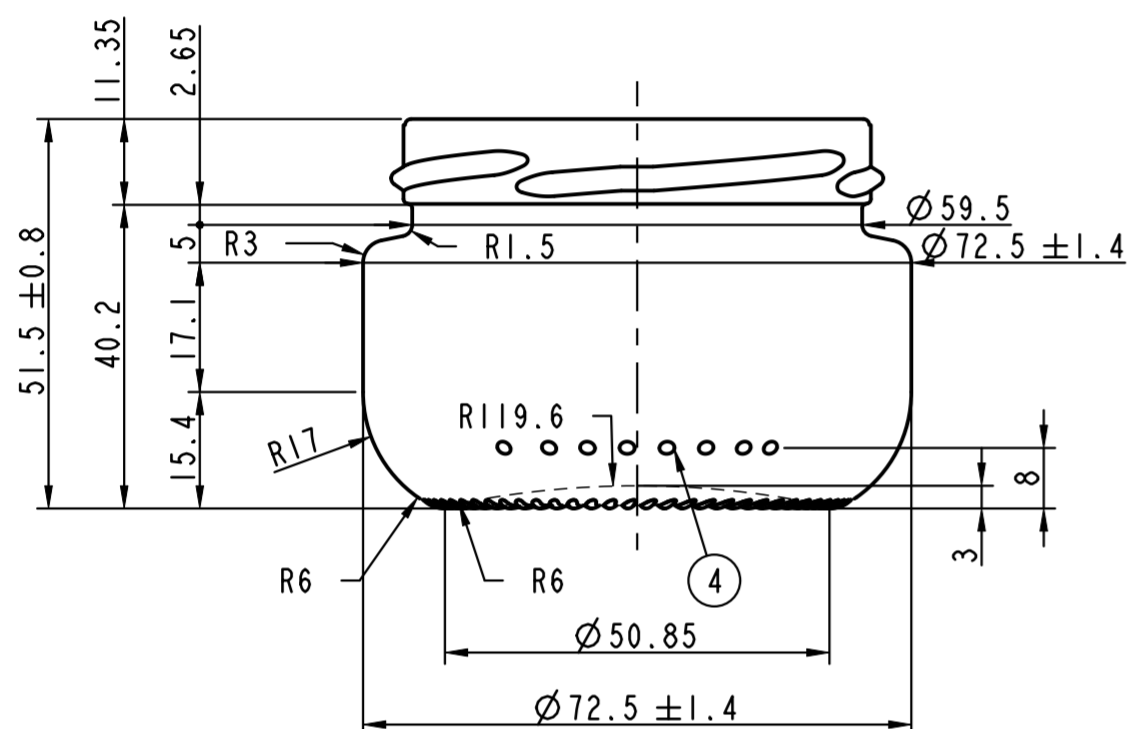

1 = TRADEMARK
2 = CAVITY No.
3 = STIPPLING
THE SHAPE OF STIPPLES IS ONLY AN
INDICATION AND THE CONSTRUCTION IS AT
THE PRODUCTION PLANT DISCRETION.
4 = CAVITY CODE

SCALE 1:1

HEAT TREATMENT XX °C maxi	CARBONATION XX g CO ₂ /l maxi
VERTICAL LOAD 150 daN maxi	THERMAL SHOCK 42 °C maxi
CATEGORY FOOD	TILT ANGLE 53.08°
MAX. VERTICALITY TOLERANCE 1.5 mm	MEASURING CONTAINER NO
FINISH SAP NUMBER 5057	FINISH REF. CETIE GME 20-06 1995
MINIMUM THROUGH BORE . mm	MAX FILLING TUBE Ø mm

CONTAINER OVERFLOW CAPACITY (BRIMFUL)
140ml ± 4,2ml

CONTAINER RATED CAPACITY (FILLPOINT)

CONTAINER WEIGHT
100g APPROX.

FINISH DESIGNATION
FR_66_GME 20-06_H113,5_5057

MAX GAS VOLUME

PROCESS RETURNABLE NO DESIGN REF.

14 CL 4 ONZAS

DESIGNER BCO DATE 15/12/08

CHECKED DATE

DRAWING NUMBER 080366

MOULD/SAP NUMBER 019167

No	DATE	REVISIONS	DESIGN/CHECK
3	05/07/21	ADD YEAR NUMBER	BCO
2	24/03/09	CRESCENT STIPPLES REPLACE KNURLING	BCO
1	16/02/09	CREATION FROM VERSION 01	BCO